

ACTIVITY FIELDS



SOLAR THERMAL



BIOMASS



FOSSIL FUELS

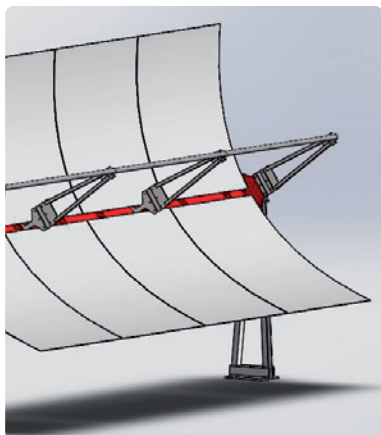

Comprehensive Management of Power Plants

Ingeteam provides comprehensive and customized solutions in the field of power generation, integrating Ingeteam range of products to maximize the profitability of the projects.

EPC / turnkey projects

- Project management.
- Engineering.
- Equipment supply.
- Construction.
- Commissioning.

Services

- Feasibility studies.
- Conceptual engineering.
- Basic and detail engineering.
- Owner engineering.
- Construction supervision.
- Commissioning.
- Operation and maintenance.

PRODUCT CHARACTERISTICS

SCE (Solar Colector Element)

Length	6 m
Aperture	2.55 m
Net Reflective Surface SCE	14.5 m ²
Solar Concentration Ratio	40
Maximun Operation Wind	50 km/h
Gust Maximun Operation Wind	80 km/h
Security position Maximun Wind	140 km/h
Reflective Surface	Mirror, film, aluminium

Solar Thermal: thermal generation

POWER PLANTS



Solar field



Thermal storage



Primary fuel



Boiler

- | Industrial processes
- | Chemical industry
- | Petrochemistry industry
- | Mining
- | Heat generation
- | Refrigeration
- | Desalination

- 1. Solar Field:** Reflective surface concentrate solar radiation in the parabolic trough collector receiver tubes, heating heat transfer fluid, named HTF, to desired temperature.
- 2. Thermal Energy Storage:** Solar thermal energy excess not used by thermal module is stored with the purpose to increase autonomy and integration with the existing thermal generation system.
- 3. Pump and Control Module:** Host heat transfer fluid pumping equipment, control system and auxiliary systems.
- 4. Meteorological Station:** It allows checking the correct operation for the solar thermal plant and verifies thermal generation guarantees.

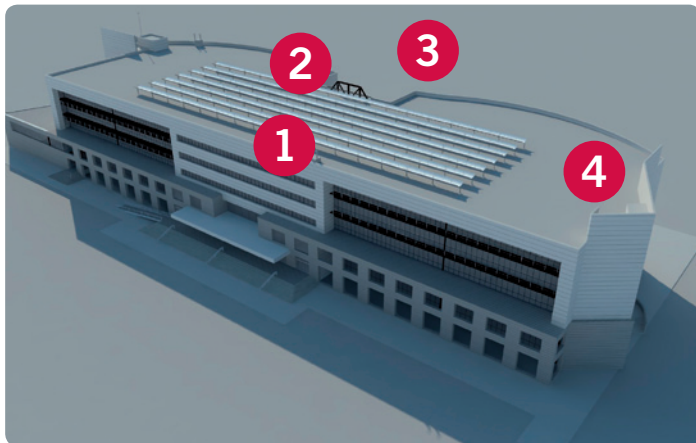

Rooftop Plant

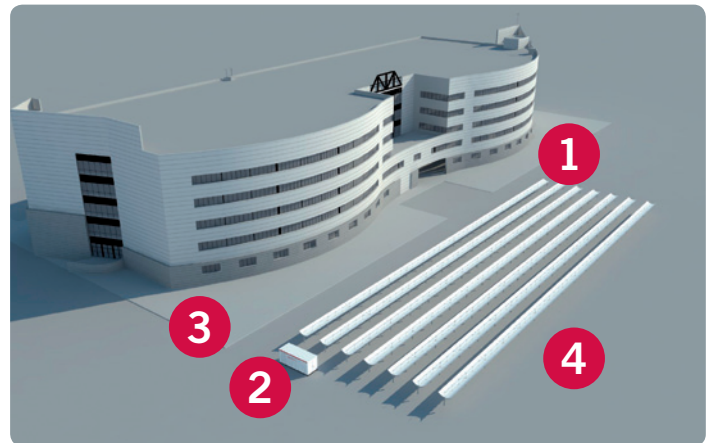

Ground Plant

ADVANTAGES

- | **Saving:** CST technology allows conventional fuel saving and reduce dependence on supply, reducing operation costs.
- | **Simple:** Simple and fast assembly with low operation and maintenance cost.
- | **Automated:** Automated solution and integrated with boiler backup.
- | **Renewable Solutions:** Carbon footprint and CO₂ emissions reduction.